

East Pavilion Exhibit Hall

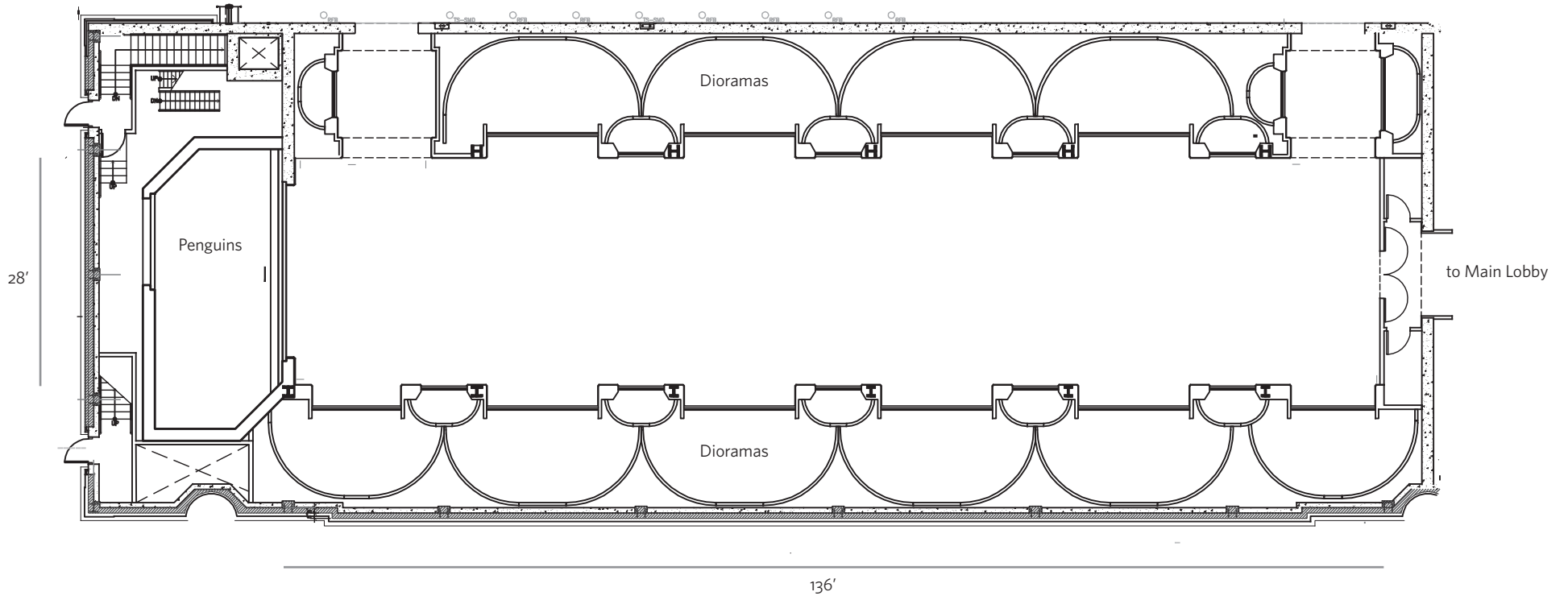

CALIFORNIA
ACADEMY OF
SCIENCES

African Hall

All measurements and capacities are approximate.
Inspecting the space in person is recommended
prior to planning your event.

For more information, email spevents@calacademy.org.

Square Footage: 4,800
Reception Capacity: 400
Seated Capacity: 280

East Pavilion
Exhibit Hall

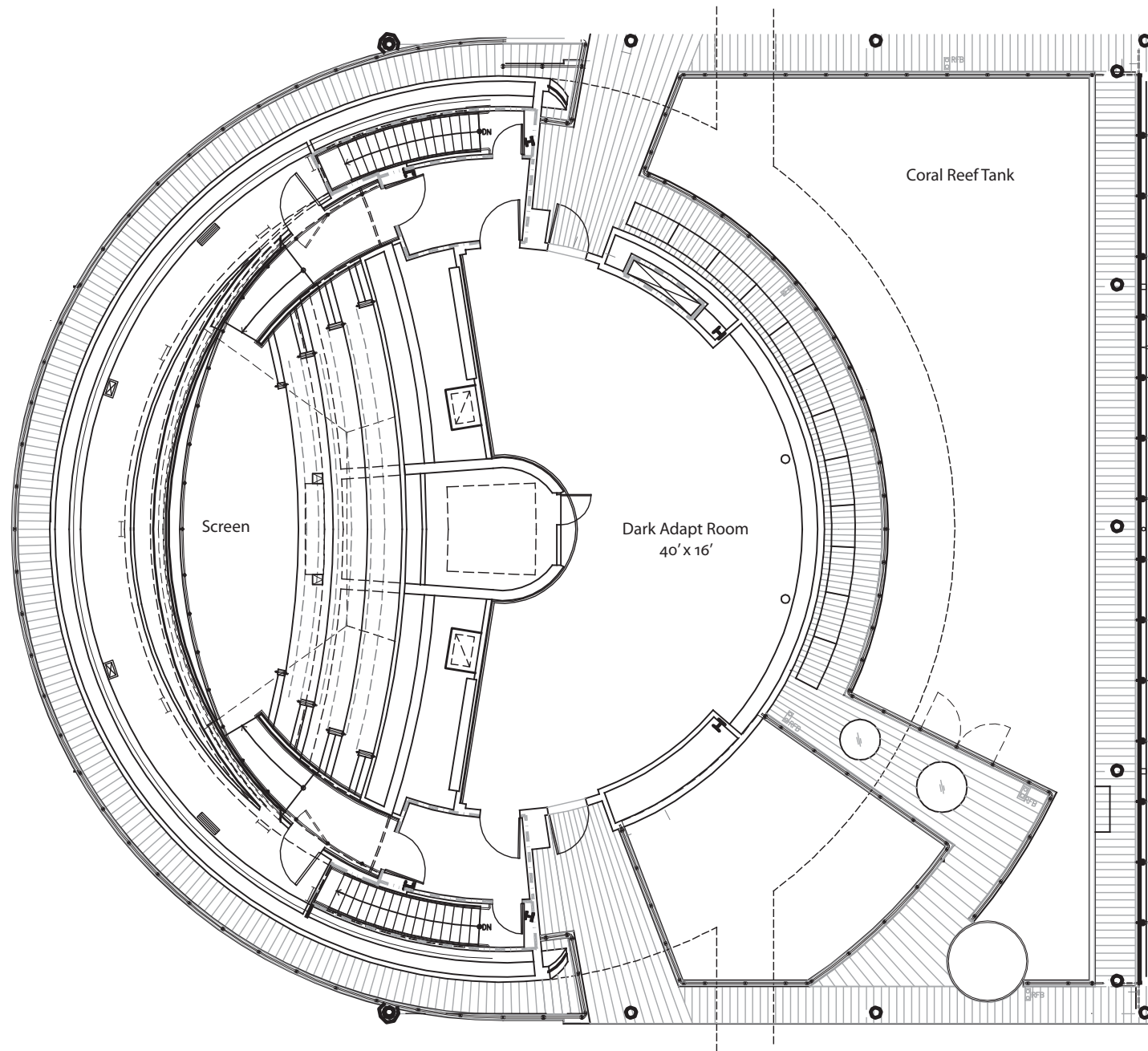

Planetarium

All measurements and capacities are approximate.
Inspecting the space in person is recommended
prior to planning your event.

For more information, email spevents@calacademy.org.

Dark Adapt Room:
Square Footage: 1,300
Reception Capacity: 100
Seated Capacity: 50



CALIFORNIA
ACADEMY OF
SCIENCES

to East Pavilion
Exhibit Hall

to West Pavilion
Exhibit Hall

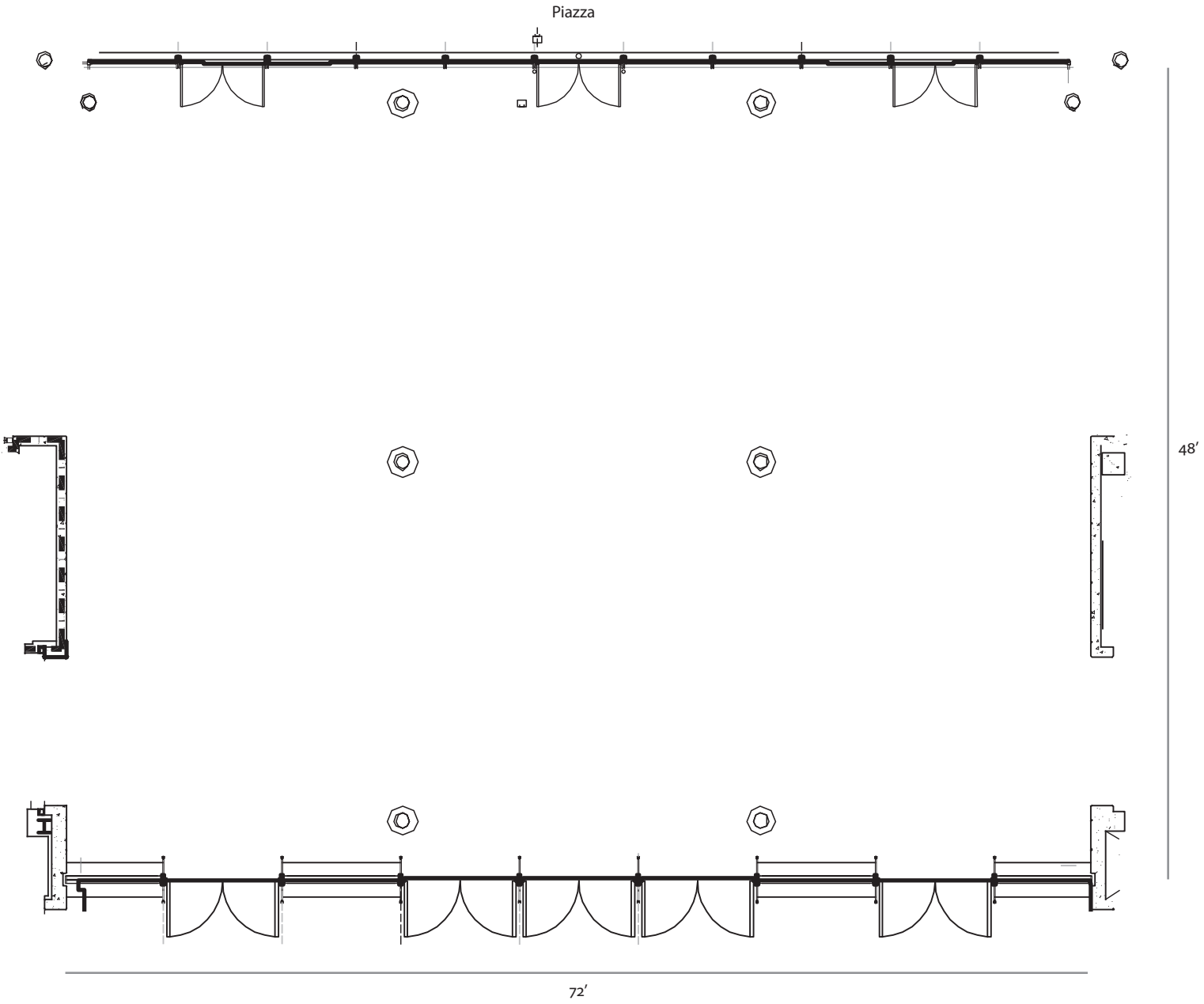

CALIFORNIA
ACADEMY OF
SCIENCES

Main Lobby

All measurements and capacities are approximate.
Inspecting the space in person is recommended
prior to planning your event.

For more information, email spevents@calacademy.org.

Square Footage: 4,100
Reception Capacity: 400
Seated Capacity: 280

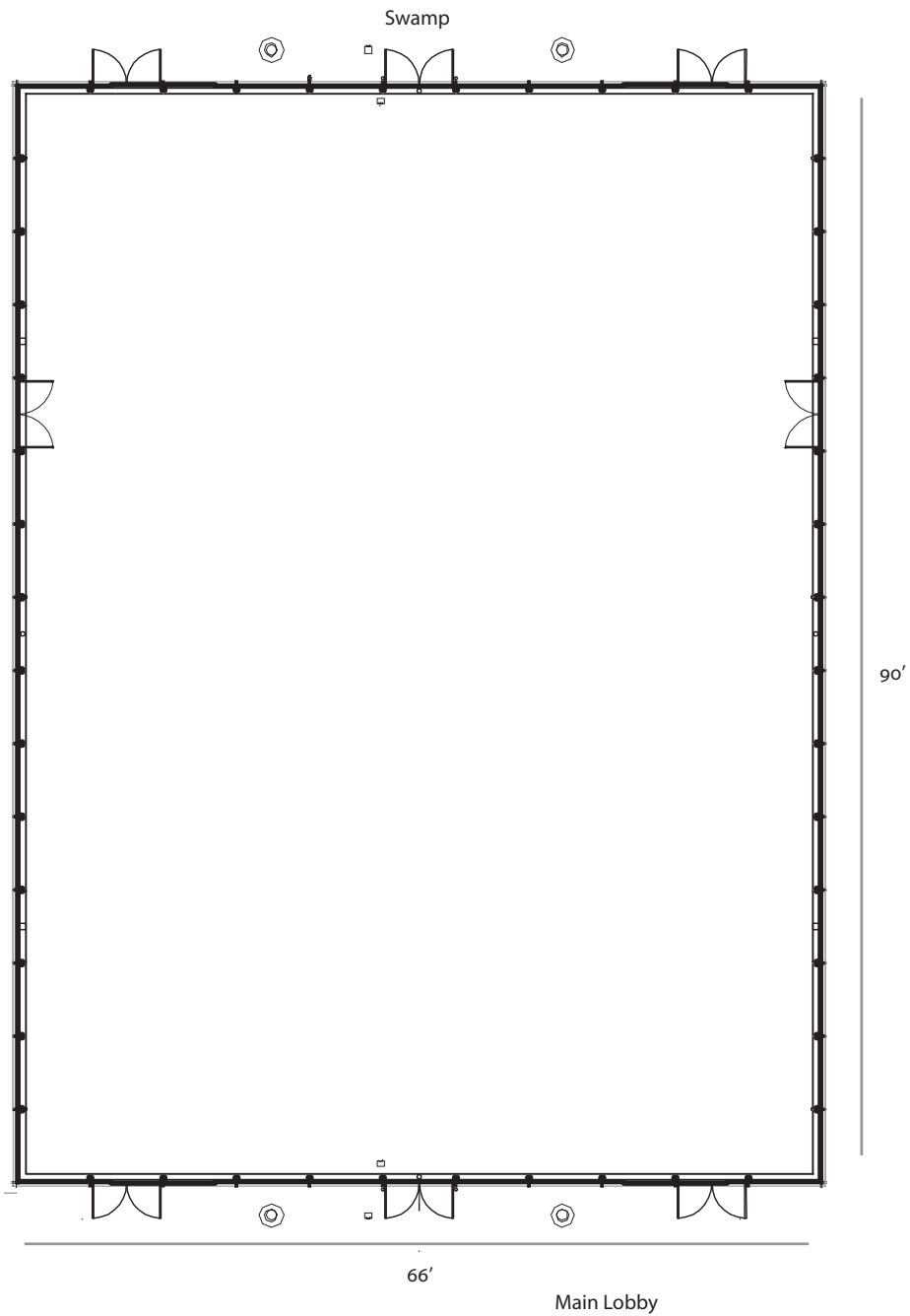

Planetarium
and Coral Reef tank

Rainforest
and California
Coast tank

90'

66'

Main Lobby



CALIFORNIA
ACADEMY OF
SCIENCES

Piazza

All measurements and capacities are approximate.
Inspecting the space in person is recommended
prior to planning your event.

For more information, email spevents@calacademy.org.

Square Footage: 5,900
Reception Capacity: 400
Seated Capacity: 280

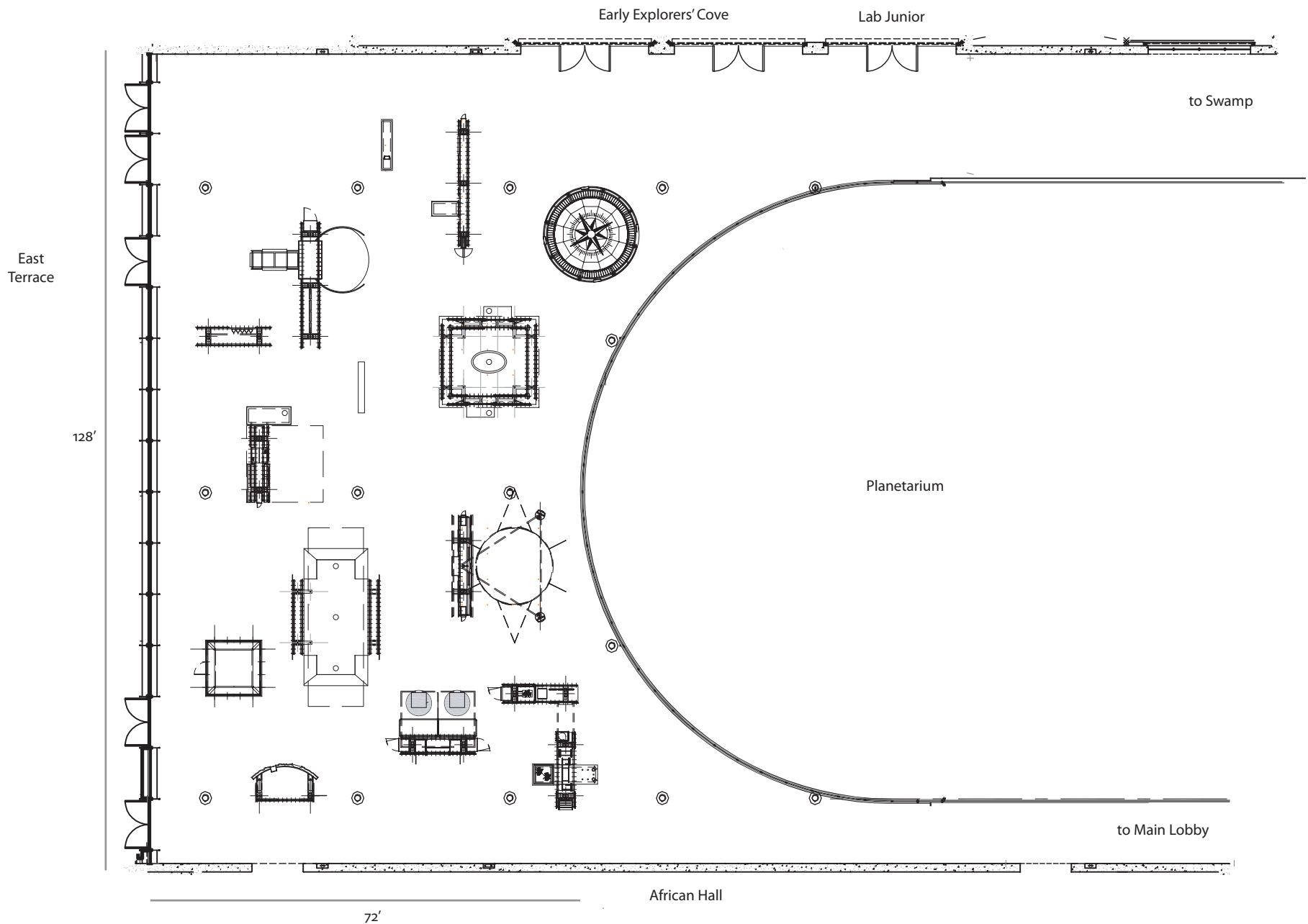

CALIFORNIA
ACADEMY OF
SCIENCES

East Pavilion Exhibit Hall

All measurements and capacities are approximate.
Inspecting the space in person is recommended
prior to planning your event.

For more information, email spevents@calacademy.org.

Square Footage: 10,000
Reception Capacity: 400
Seated Capacity: 200

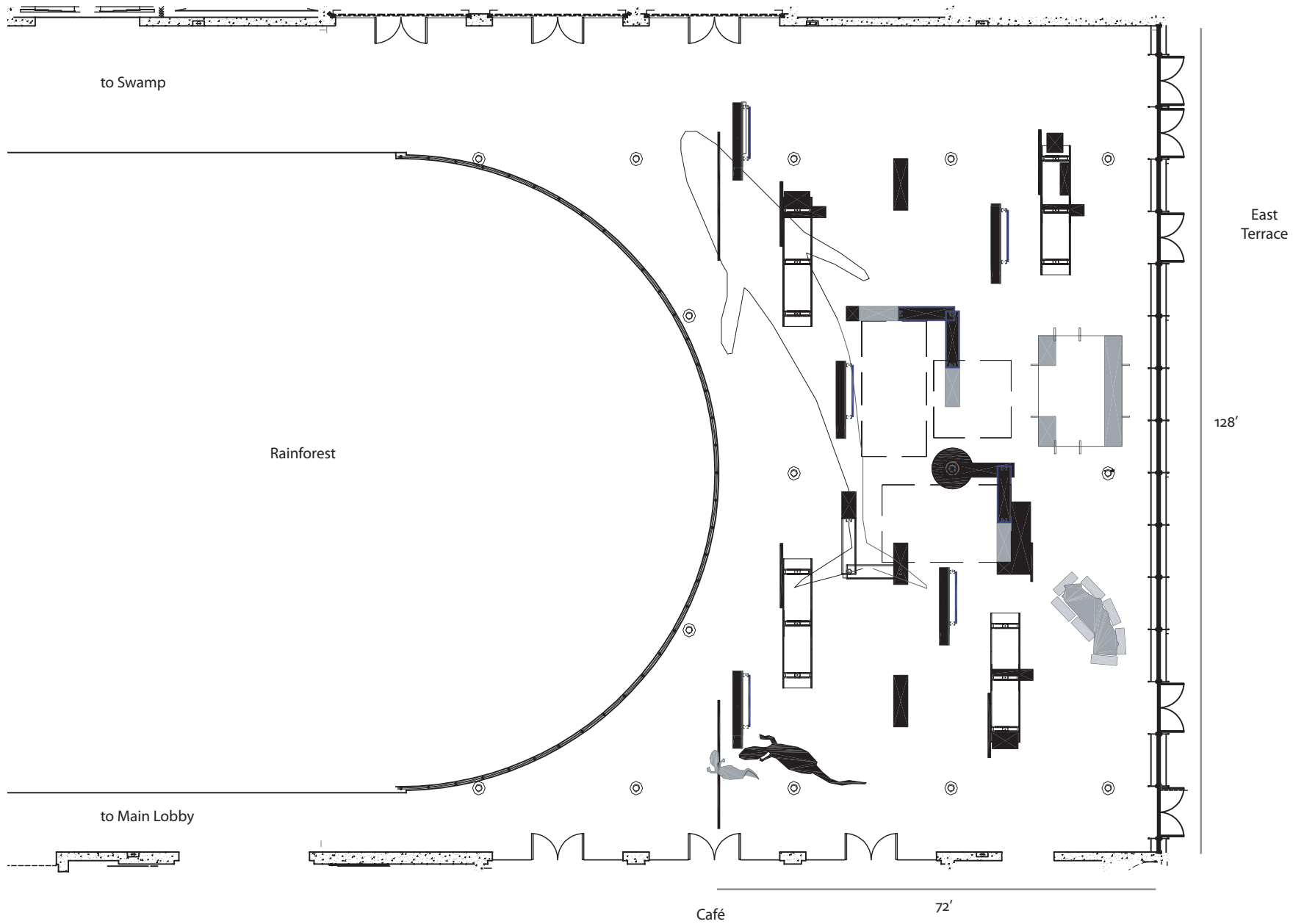

CALIFORNIA
ACADEMY OF
SCIENCES

West Pavilion Exhibit Hall

All measurements and capacities are approximate.
Inspecting the space in person is recommended
prior to planning your event.

For more information, email spevents@calacademy.org.

Square Footage: 10,000
Reception Capacity: 400
Seated Capacity: 200

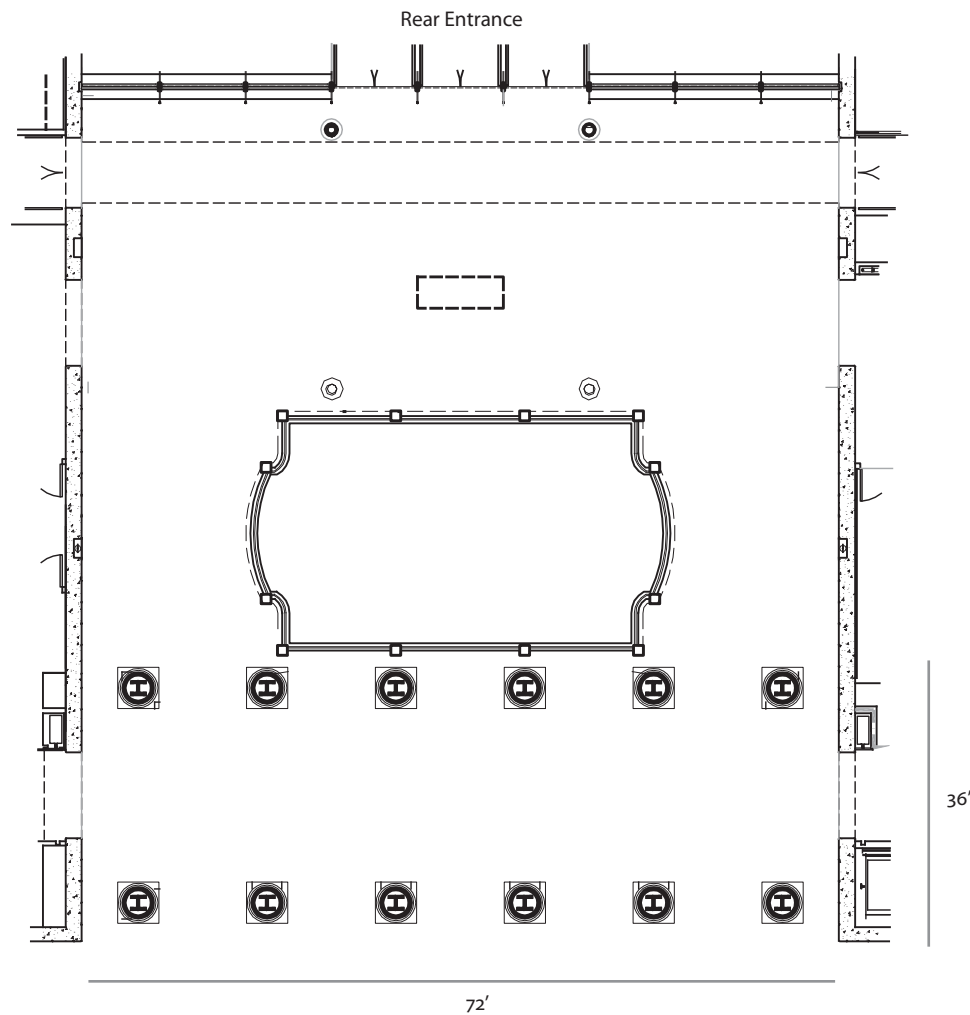

to East Pavilion
Exhibit Hall

to West Pavilion
Exhibit Hall

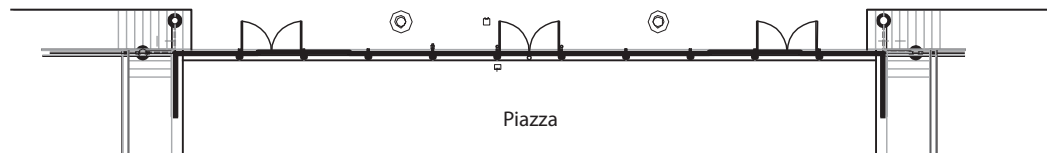

CALIFORNIA
ACADEMY OF
SCIENCES

Swamp

All measurements and capacities are approximate.
Inspecting the space in person is recommended
prior to planning your event.

For more information, email spevents@calacademy.org.

Square Footage: TBD
Reception Capacity: 150
Seated Capacity: 80

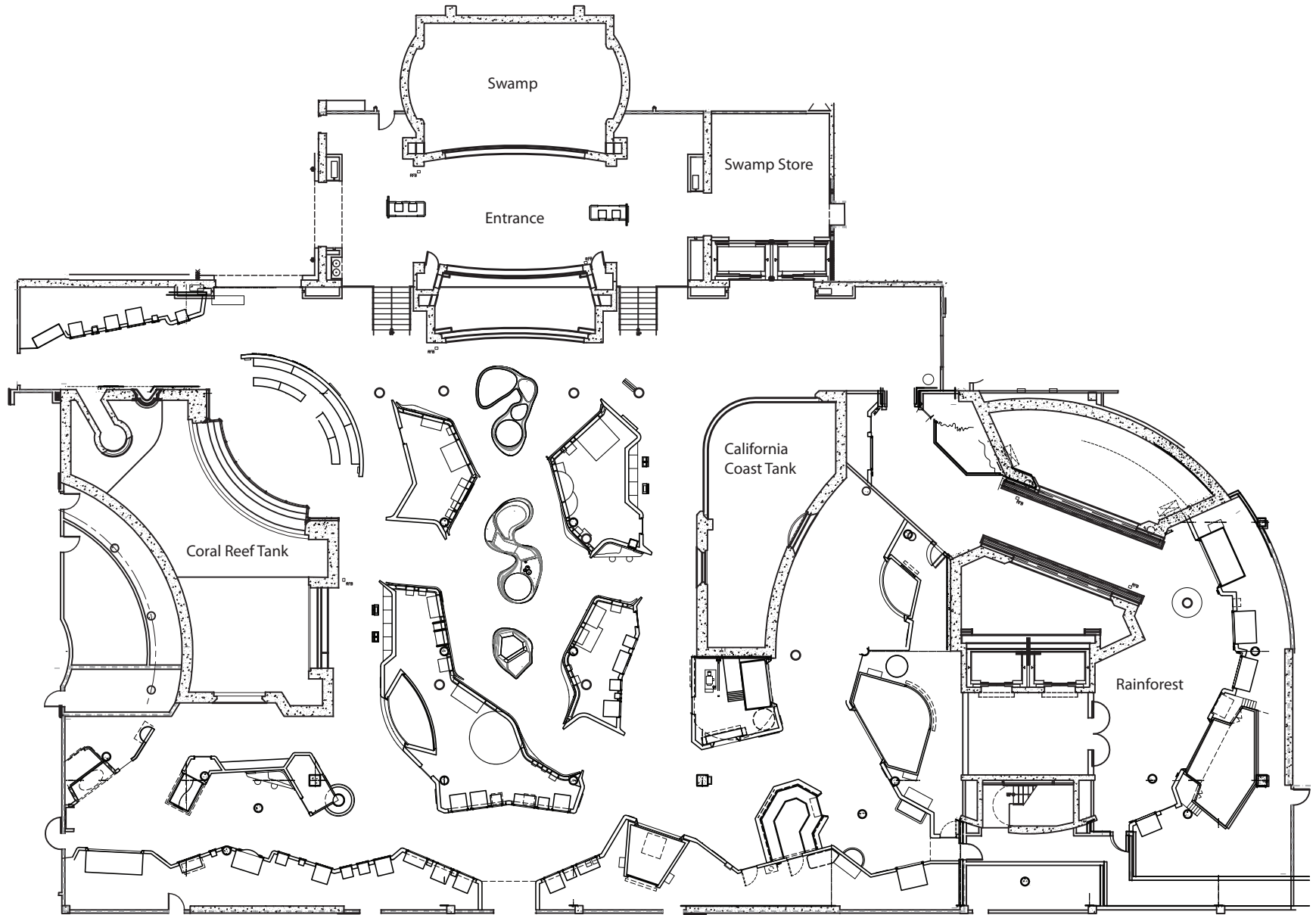

CALIFORNIA
ACADEMY OF
SCIENCES

Aquarium

All measurements and capacities are approximate.
Inspecting the space in person is recommended
prior to planning your event.

For more information, email spevents@calacademy.org.

Reception Capacity: 250

Seated Capacity: 100

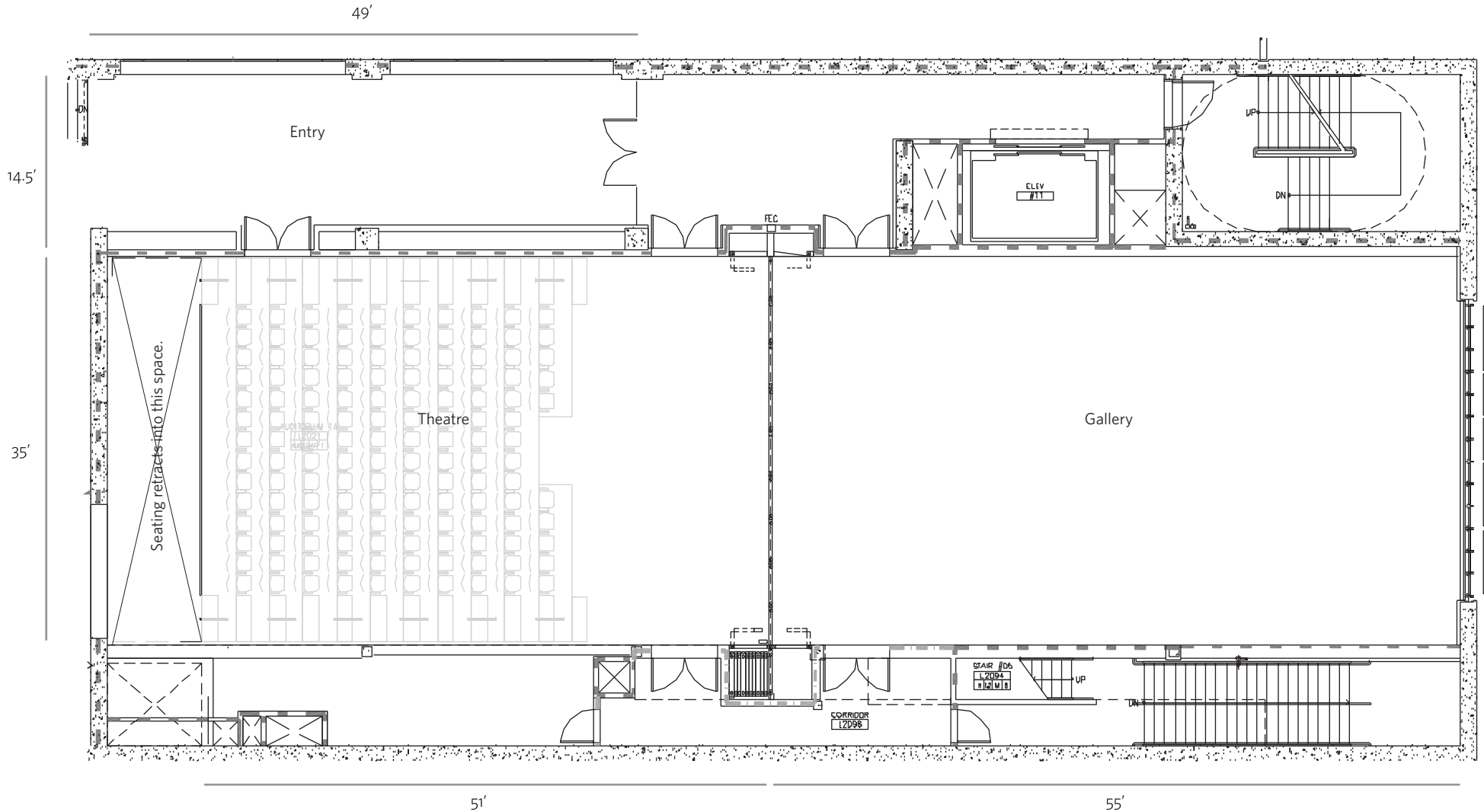

CALIFORNIA
ACADEMY OF
SCIENCES

Forum (Gallery and Theatre)

**The Forum will be unavailable for rental due to Extreme Mammals exhibit:
January 4th, 2010 - October 1st, 2010**

All measurements and capacities are approximate.
Inspecting the space in person is recommended
prior to planning your event.

For more information, email spevents@calacademy.org.

Square Footage: 4,000 (Theatre: 2,000, Gallery: 2,000)

Reception Capacity: 400 (Theatre: 200, Gallery: 200)

Seated Capacity: 280 (Theatre: 140, Gallery: 140)

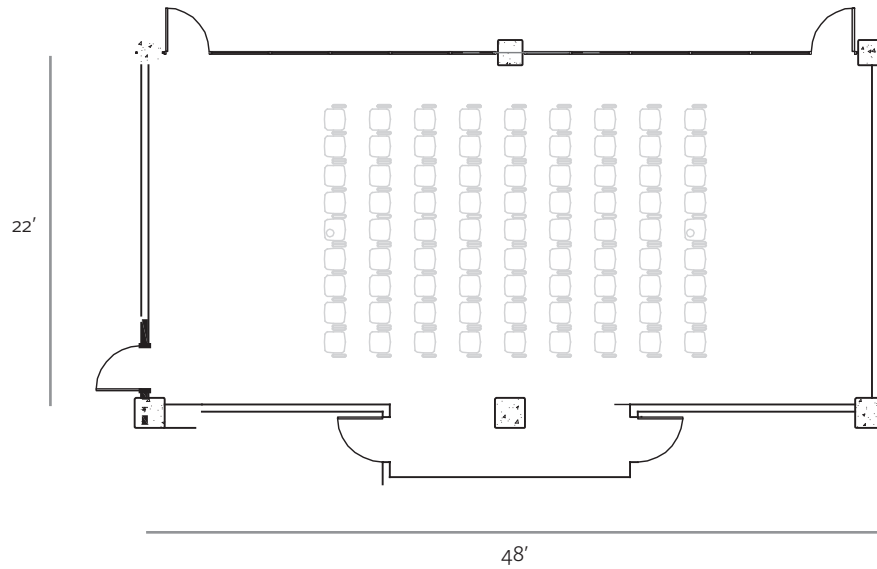

CALIFORNIA
ACADEMY OF
SCIENCES

Boardroom

All measurements and capacities are approximate.
Inspecting the space in person is recommended
prior to planning your event.

For more information, email spevents@calacademy.org.

Square Footage: 1,250
Reception Capacity: 120
Seated Capacity: 70